

## Unión orientable macho cilíndrico - RPB MG



### Rosca macho BSPP

G 1/8

### Para tubo Ø ext. (mm)

4

### Presión de uso

0 a 10 bar

### Temperatura

0°C a + 60°C

### Material

Polímero y latón niquelado

## Descripción

Referencia	Rosca macho BSPP	Para tubo Ø ext. (mm)
<b>RPB MG0400</b>	G 1/8	4
<b>RPB MG0401</b>	G 1/4	4
<b>RPB MG0500</b>	G 1/8	5
<b>RPB MG0501</b>	G 1/4	5
<b>RPB MG0502</b>	G 3/8	5
<b>RPB MG0503</b>	G 1/2	5
<b>RPB MG0600</b>	G 1/8	6

Referencia	Rosca macho BSPP	Para tubo Ø ext. (mm)
<b>RPB MG0601</b>	G 1/4	6
<b>RPB MG0602</b>	G 3/8	6
<b>RPB MG0603</b>	G 1/2	6
<b>RPB MG0800</b>	G 1/8	8
<b>RPB MG0801</b>	G 1/4	8
<b>RPB MG0802</b>	G 3/8	8
<b>RPB MG0803</b>	G 1/2	8
<b>RPB MG1000</b>	G 1/8	10
<b>RPB MG1001</b>	G 1/4	10
<b>RPB MG1002</b>	G 3/8	10
<b>RPB MG1003</b>	G 1/2	10
<b>RPB MG1201</b>	G 1/4	12
<b>RPB MG1202</b>	G 3/8	12
<b>RPB MG1203</b>	G 1/2	12
<b>RPB MG1602</b>	G 3/8	16
<b>RPB MG1603</b>	G 1/2	16

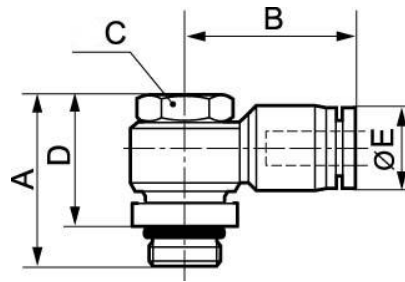

### Dimensions

Referencia	A mm	B mm	C mm	D mm	E mm
<b>RPB MG0400</b>	23.5	23.5	10	18	10
<b>RPB MG0401</b>	28	28	14	22	10
<b>RPB MG0500</b>	23.5	23.5	10	18	12.8
<b>RPB MG0501</b>	28	28	14	22	12.8
<b>RPB MG0502</b>	34	34	19	27.5	12.8
<b>RPB MG0503</b>	38	38	24	30	12.8
<b>RPB MG0600</b>	23.5	23.5	10	18	12.8
<b>RPB MG0601</b>	28	28	14	22	12.8
<b>RPB MG0602</b>	34	34	19	27.5	12.8
<b>RPB MG0603</b>	38	38	24	30	12.8
<b>RPB MG0800</b>	23.5	24.6	10	18	13.8
<b>RPB MG0801</b>	28	26.8	14	22	13.8
<b>RPB MG0802</b>	34	28.8	19	27.5	13.8
<b>RPB MG0803</b>	38	30.5	24	30	13.8
<b>RPB MG1000</b>	23.5	28.5	10	18	16.8
<b>RPB MG1001</b>	28	31	14	22	16.8
<b>RPB MG1002</b>	34	31	19	27.5	16.8

Referencia	A mm	B mm	C mm	D mm	E mm
<b>RPB MG1003</b>	38	34	24	30	16.8
<b>RPB MG1201</b>	28	32	14	22	19.8
<b>RPB MG1202</b>	34	34	19	27.5	19.8
<b>RPB MG1203</b>	38	36	24	30	19.8
<b>RPB MG1602</b>	34	34.8	19	27.5	23.8
<b>RPB MG1603</b>	38	36.6	24	30	23.8